

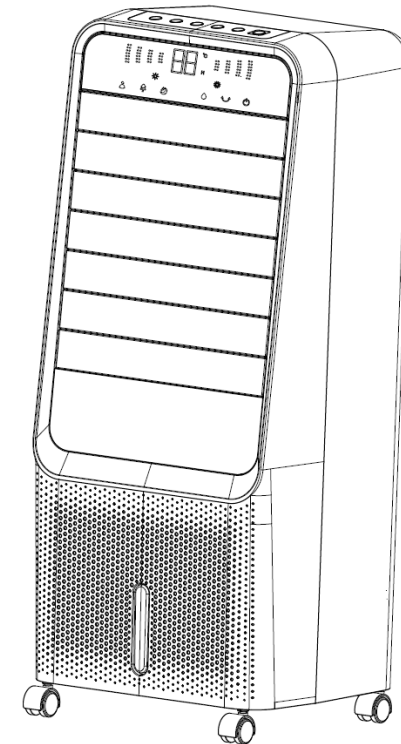

AIR COOLER & HEATER - PROKORD AIR 2020

DF-AF1838KH USER'S MANUAL



Dustin Group AB

Address: Box 1194, SE-131 27 Nacka Strand, Sweden

Tel: 46 8 553 44 000

<https://www.dustin.se>

Please read the User's Manual carefully before using the product in order to achieve its best performance. And please retain the manual for future reference.

We hope that our products would bring convenience and enjoyment to your life!

Content

I. Safety Warnings and Precautions.....	2
II. Features.....	3
III. Names of Product Components.....	5
IV. Product Installation and Usage.....	8
V. Cleaning and Maintenance.....	15
VI. Technical Parameters.....	17
VII. Environmental Protection.....	17

I. Safety Warnings and Precautions

- Please read all instructions carefully before using this product.
- Please check the voltage corresponds with the voltage (220V-240V~50Hz) marked on the rating label before operating.
- This appliance is not intended for use by persons (including children) with reduced physical, sensory or mental capabilities, or lack of experience and knowledge, unless they have been given supervision or instruction concerning use of the appliance by a person responsible for their safety.
- Children shall not play with the appliance. Cleaning and user maintenance shall not be made by children without supervision.
- Children of less than 3 years should be kept away unless continuously supervised.
- Children aged from 3 years and less than 8 years shall only switch on/off the appliance provided that it has been placed or installed in its intended normal operating position and they have been given supervision or instruction concerning use of the appliance in a safe way and understand the hazards involved.
- **CAUTION — Some parts of this product can become very hot and cause burns. Particular attention has to be given where children and vulnerable people are present.**
- **WARNING:** In order to avoid overheating, do not cover the appliance.
- Do not use this appliance in the immediate surroundings of a bath, a shower or a swimming pool.
- Do not use if there are visible signs of damage to the appliance.
- Place the appliance on a flat horizontal surface, and do not tilt it when using.
- **WARNING:** Do not use this appliance in small rooms when they are occupied by persons not capable of leaving the room on their own, unless constant supervision is provided.
- **WARNING:** To reduce the risk of fire, keep textiles, curtains, or any other flammable material a minimum distance of 1 m from the air outlet.

- If the supply cord is damaged, it must be replaced by the manufacture, its service agent or similarly qualified persons in order to avoid a hazard.
- When not using the appliance, unplug the power cord. Pull the plug instead of the power cord.
- Make sure that the appliance does not touch any obstacles while it is running.
- When the appliance is running, do not put your fingers or other objects into the air inlet and outlet. If there are children nearby, you should pay more attention to avoid children playing with the appliance.
- When the appliance is running, do not put soft objects such as hair or curtain close to the appliance to avoid getting caught in the fan.
- When the power cord or plug of the appliance is damaged, or the fan is damaged due to falling off, please stop using the product.
- Do not put any object on the power cord. Place the power cord properly to avoid tripping over.
- Do not use this appliance outdoors. It is for indoor use only.
- Do not use this appliance near the window or in direct sunlight.
- Do not use the appliance together with other semi-conductors.
- Do not use this appliance where gasoline, paint or other flammable materials are stored.
- Do not disassemble the appliance without permission. For repair, please return it to the repair center.
- Unplug the power cord before cleaning, repairing or moving the product.
- The product should be kept clean and regularly maintained.

II. Features

- (1) With 6-meter infrared remote-control function.
- (2) Cooling/humidifying and heating (cooling 110W; heating: low level 1200W, high level 2000W).
- (3) Temperature can be set from 15°C~35°C during heating state.
- (4) Electronic button control, digital display timer and room temperature.

- (5) Four wind modes: Normal, smart, natural and sleeping. Normal wind has no LED display, and the default is normal wind when the appliance is started.
- (6) Four wind speeds: High, middle, low and silent.
- (7) Wind swing: Automatic left-right swinging (wind direction rotates by 80° when the blades rotate), manual up-down swinging.
- (8) Timer function (1-8hrs): The timer time is increased by 1H, and the maximum timer time is 8h.
- (9) Power off memory function: resume to original setting in 30 seconds after power on.
- (10) Horizontal blades can be closed completely after turning off the unit to prevent dust.
- (11) With HEPA (High Efficiency Particulate Air) filter to better purify air.
- (12) Thickened cooling pad effectively promotes water evaporation and better cooling/humidifying effect.
- (13) Spray water circulation cooling technology is adopted, with large circulating water volume and fast cooling speed.
- (14) Removable 6-litre drawer-style water tank which is convenient for cleaning.
- (15) Tank water shortage protection.
- (16) Universal casters for easy movement.

III. Names and Product Components

● Product structure

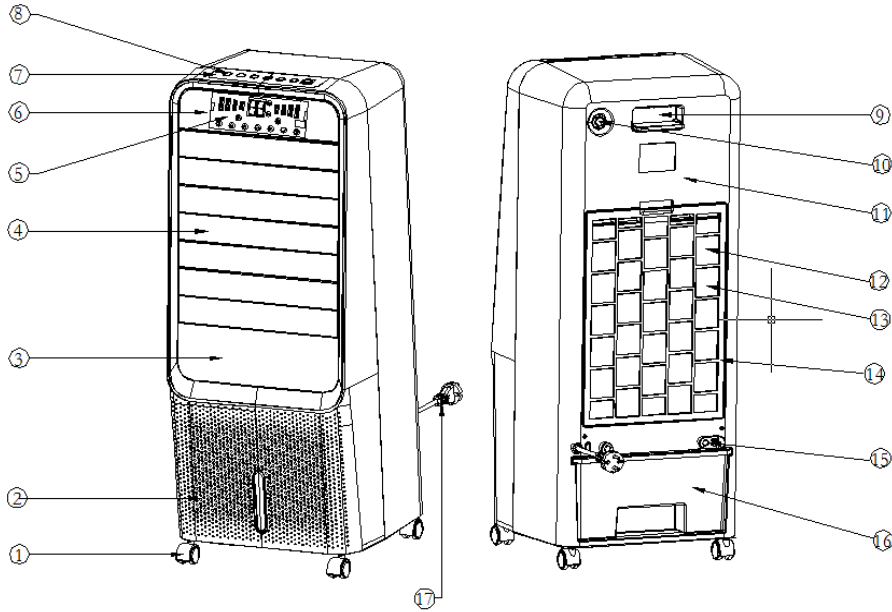

- | | | |
|-----------------------------|------------------------|-----------------------------------|
| 1. Casters | 2. Front shell | 3. Decorative blade |
| 4. Horizontal blades | 5. PVC surface sticker | 6. Display board |
| 7. Button board | 8. Buttons | 9. Rocker switch |
| 10. Remote control | 11. Back shell | 12. Cooling pad |
| 13. HEPA filter and bracket | 14. Dustproof filter | 15. Power cord reel/
tank lock |
| 16. Water tank | 17. Power cord | |

● Diagram of operation panel



● Diagram of display panel

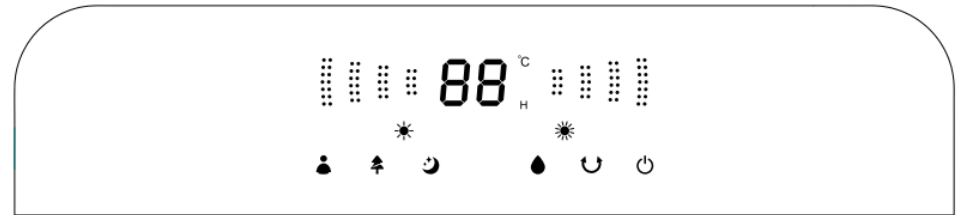

● Accessory 1- remote control

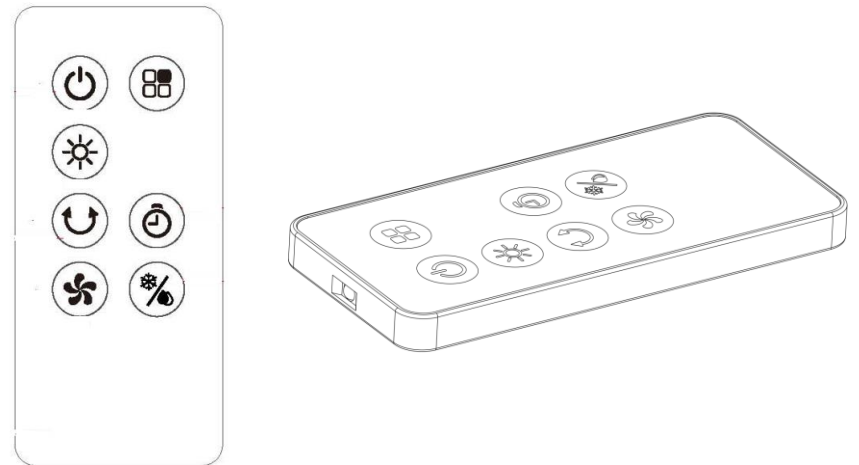

Use of remote control:

1. First open the battery cover on the back of the remote control and install a 3V CR2032 battery.

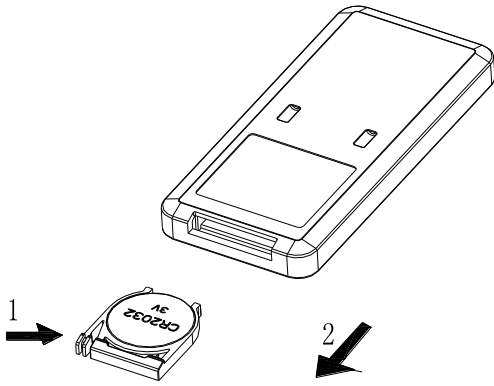

Method for opening the battery cover: firstly, press in the direction shown by arrow 1 to break away the upper buckle of the battery cover, then pull out of it in the direction shown by arrow 2.

2. When using, please aim at the receiver position.

4. When the battery is running out, battery cover can be pulled out in the direction shown in the figure, please replace the battery (CR2032 3V). Please pay attention

to the positive and negative terminals of the battery. Then, battery cover should be reset for usage.

- Accessory 2- ice packs (two pcs per unit)

Use of ice pack:

The ice pack has a unique cold storage and heat preservation property, which can slowly absorb the heat in the water and make the water temperature in the water tank always lower than the ambient temperature for several hours, so that the air blown out by the air conditioner fan is cooler.

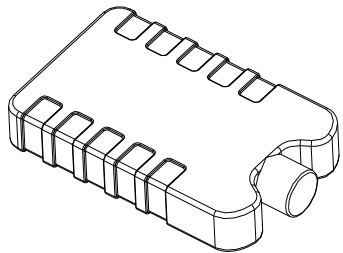

1. Place the ice pack in the freezer of the refrigerator until the ice pack is completely frozen.

2. Insert an ice pack that has been frozen into the

water tank and push the water tank back into place. After about ten minutes, the water temperature in the water tank will be lower than the ambient temperature.

3. This unit is equipped with two ice packs to ensure continuous use.

4. It is strictly forbidden to open/refill the ice pack or swallow its contents.

IV. Installation and Usage

Remove plastic cover from HEPA filter before use.

1. Remove screws from HEPA bracket

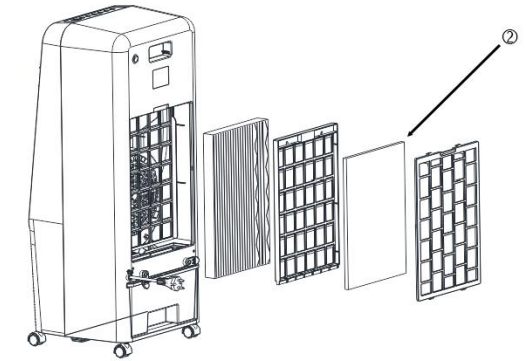
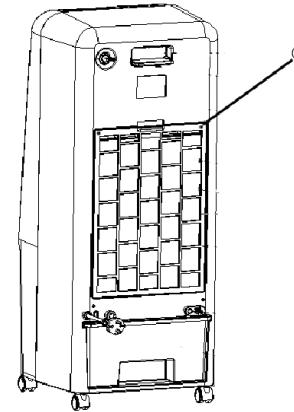

2. Remove HEPA filter

3. Remove plastic bag from HEPA filter

4. Reinstall the HEPA filter and bracket

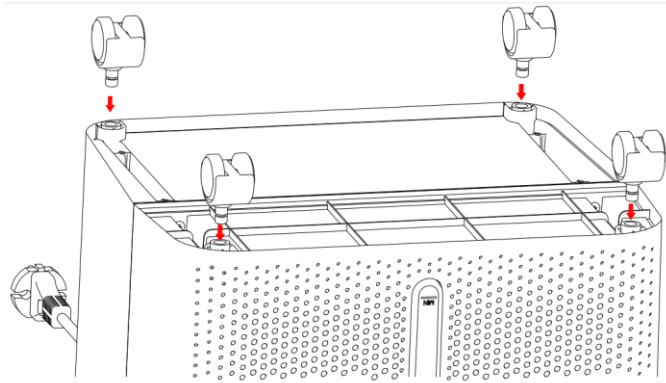

Attachment of the caster rollers may be required. The caster is placed into the hole in the direction of the arrow until the metal end of the caster contacts the plastic end.

● Usage of function buttons

1. “ON/OFF” button

After power on, the buzzer beeps twice, indicating the system enters the standby state. When the indicator has been lighting for 1 minute without any button pressed, it darkens 30% of original luminance; if the button is used at this time, it becomes bright again.

After power on, press the **ON/OFF** button to startup to enter the default operating state. (Note, only power cord plug is firstly pulled out to enter the default operating state; if the appliance is closed without pulling out the plug of power cord, when ON/OFF button is pressed, startup state in the last time can be memorized, excluding Timer and sleeping mode) and the default operating state is as follows:

- Normal wind mode; No LED display;
- Power indicator is ON;
- Swing indicator is OFF;
- Cooling/humidifying indicator is OFF;
- Medium wind is started up and transferred to low-speed after 3s and low-speed indicator is ON;

- Timer function is OFF and the indicator is OFF;
- Ambient temperature indicator is ON;
- Ambient temperature is displayed.

2. “SPEED” button

Press the **SPEED** button to adjust the wind speed, which is successively low →medium →high → silent → low, and then re-circulates, and corresponding indicators of four wind speeds are ON. (Note: the silent speed can only be operated under normal wind mode, which is not applicable for other modes).

3. “MODE” button

Press the **MODE** button to select the 4 wind modes (normal wind, smart wind, natural wind, sleeping wind) when the appliance is in cool wind state (the button is invalid when it is in heating function), the wind speed of the appliance is automatically changed to adapt the air flow to the conditions required by the selected mode. There is no LED indicator icon for normal wind. In the other three modes, corresponding LED indicators are ON.

- Normal wind: Operate at the set constant wind speed.
- Natural wind : This is a preprogrammed mode that automatically changes the wind speed cyclically from high to medium to low, creating a natural wind movement. In this mode, the “SPEED” button allows you to choose the high, medium or low air flow program. However, the display panel only displays the initial speed (high, medium, low). All other speeds activated and deactivated automatically are not displayed on the screen. (Note: when it is at silent speed, wind modes cannot be adjusted).

Rules for wind operation in the natural wind mode are as follows:

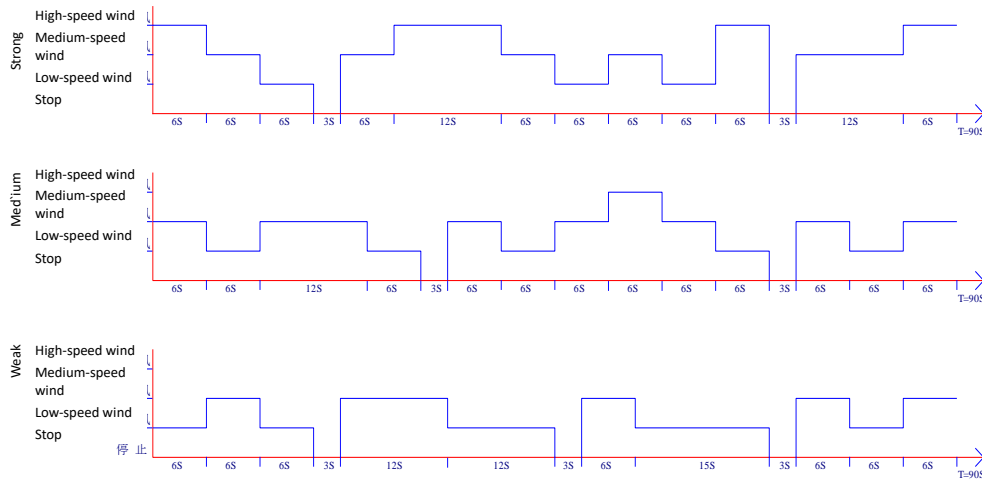

Sleeping wind : Operate at the speed set by the user and reduces the speed according to the preset rules. This mode prevents people from physical discomfort due to high speed wind during sleeping. Rules for wind operation in the natural wind mode are as follows:

- High speed: 30 minutes high natural wind → 30 minutes medium natural wind → low natural wind
- Medium speed: 30 minutes medium natural wind → low natural wind
- Low speed: Keep operating at low natural wind

- **Smart wind** : When the ambient temperature surrounding the appliance is below 25°C, operate at a low speed; if between 25°C and 29°C, operate at a medium speed; if above 29°C, operate at a high speed. (Note: In this mode, the wind speeds cannot be adjusted, and the wind speed indicators don't change with the speed).

In this mode, the LED indicator icon flashes at 0.5s on/off to indicate the state of smart wind mode; if press the button at this time, it is exit from the smart wind mode to next mode wind, and the indicator is no longer flashing.

4. “TIMER” button

- a) Press the **TIMER** button continuously to select the running time from 1 to 8 hours in 1-hour increments. During this selection process, the indicator light in the display panel flashes every 0.5 s. You can also press and hold the **TIMER** button for 2 s to scroll quickly every 0.2 s to set the timer value.
- b) If you do not press any other button within 5 seconds, the device will start counting down the specified time and alternately display the remaining time and room temperature on the display panel.
- c) Deactivation: At any time during the countdown, press **TIMER** and select the timer value at 0, the device deactivates the timer function and the information screen displays the information corresponding to the current operating mode.
- d) If Timer isn't set, current ambient temperature is always displayed in “°C” and the display range is between -10 to 40°C, (“LO” is displayed when the temperature is -10°C and lower, and “HI” is displayed when it is 40°C and above). If Timer is set, ambient temperature is firstly displayed for 5s and then it is switched to display the remaining Timer value for 5s, which are displayed alternately and cyclically.

5. “SWING” button



Press the **SWING** button to activate or stop the automatic left-to-right swing of vertical blades. (Note: The horizontal blades for up-and-down swing are manually adjusted).

6. “COOLER/HUMIDIFIER” button

Press the **COOLER/HUMIDIFIER** button to activate or stop the cooling/humidifying function. (Note: Always ensure the tank is filled with suitable water before attempting to use this function).

7. “HEATER” button



a) The main motor keeps running as long as the heating system [PTC (Positive Temperature Coefficient) board] is in operation. Whenever the heating system stops working, the main motor continues to work for 30 seconds and then stops.

b) Press the **HEATER** button for the first time, the heater moves to the air outlet and starts heating at low wind speed (speeds are not adjustable), and the Weak Heating works, the indicator turns on ; Press the **HEATER** button again, the weak heating works for 10s first, then the Strong Heating starts, and the indicator  turns on; Press the **HEATER** button for the third time, the heating system stops, the heater moves to the side of the air outlet after 10s, and the cool wind (no cool wind indicator) starts; The cycle repeats as above when the button is pressed.

c) Temperature setting: When it's in the heating state, press the **MODE** button to make the digital tube (88) and Led_°C show temperature status, and the digital tube turns on/off alternately by 0.5s. At this time, press the **MODE** button to adjust the temperature value, which can be set from 15°C to 35°C in 1°C increment. You can also press and hold the **MODE** button for 2 s to scroll quickly every 0.2 s to set the value. At this time, it only displays the set temperature.

d) Once the temperature is set, the temperature setting will be reset only when the temperature value is changed by using the **MODE** button, and it will take effect immediately after 5s of no operation.

e) When the timer and temperature are set at the same time, the timer and ambient temperature are displayed interactively (the set temperature is not displayed) every 5s. When the time and temperature are not set, only the ambient temperature is displayed.

f) When the ambient temperature reaches or exceeds the set temperature after 10s, the heating system stops; When the ambient temperature drops to 2°C lower than the set temperature, the heating system starts again and the corresponding heating power indicator (/) is displayed.

g) When the set temperature is equal or lower than the current ambient temperature, the heating system stops working and the wind speed is not adjustable; When the set temperature is higher than the current ambient temperature, the heating system starts working again. When set as strong heating, it starts working from weak heating first, and then switch to strong heating after 10s.

h) Press the **HEATER** button and **COOLER/HUMIDIFIER** button simultaneously for 3s to deactivate the button tone; press both buttons for 3s again to activate the tone again.

8. Power-off memory function

a) In the start-up state, when the power is restored after power-off, a beep sound is given for 10 times (1 time per second) without any indicator displayed. After 30s of waiting, all functions except the sleeping wind mode restore to the previous start-up state.

b) Press the **ON/OFF** button during the 30s waiting time after power on, the previous start-up state is restored immediately.

c) The countdown of the timer function also needs to be memorized, and an error of no more than 5 minutes is allowed for each power outage (ignoring the outage duration).

d) When it encounters a power outage when it is turned off, it remains off after power on.

9. Cooling pad drying function

After the cooling/humidifying function is used, and the cooling pad gets wet and needs to be dried for better storage. Press and hold the **SPEED** button for 3s to activate the cooling pad drying function.

When the function is activated, the wind speed jumps from the current speed to the next and then directly jumps to the high wind speed for 20 minutes, and the indicator of high speed is ON, which flashes every 0.5 seconds, other functions are invalid, and only the **ON/OFF** button works, and the appliance turns off after 20 minutes.

During the cooling pad drying function, if you press the **ON/OFF** button to shut down before 20 minutes, the remaining timing of the function will not be memorized, and all other functions is restored to the previous working state.

● Protection Function

1. Water shortage protection:

a) After the water pump works for 45s, if the software detects the water shortage for 5s, the pump stops working; the buzzer keeps beeping for 10s.

b) Press the **COOLER/HUMIDIFIER** button 3 times after power on within 3s, and then a beep sound is activated to indicating that it enters the rapid detection of water shortage protection state.

c) During the rapid detection of water shortage state, press the **ON/OFF** button, and then press the **COOLER/HUMIDIFIER** button, a water shortage alarm sounds when it detects there is no water in about 5s.

d) The rapid detection of water shortage function is cancelled after pressing the OFF button.

2. Continuous working protection function

In the default operating state after startup, when the appliance has been working continuously for 15 hours without any button pressed, it turns off automatically; If the user wants to deactivate this function, please press and hold the **COOLER/HUMIDIFIER** and **SPEED** button for 3s, then a beep sound is given by the buzzer to indicate the automatic shutdown function is deactivated.

3. Heating protection function

When the horizontal blades are closed by accident during heating state, the heating system stops working when the temperature reaches at a high point to prevent the blades from being deformed or the appliance being burned.

● **Water filling:**

Please add suitable water to the water tank before attempting to use the cooling/humidifying function, and it's necessary to firstly open the tank lock, half/completely take out the tank and fill water, and then re-lock the tank, see the below figure:

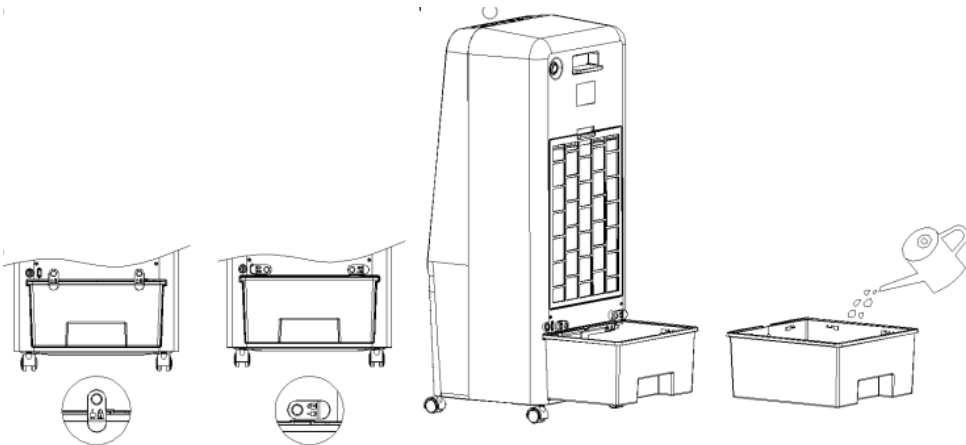

Please pay attention to the water level marked on the water tank.

1. Do not exceed the maximum level or below the minimum level.
2. Please be sure to use clean water.

V. Cleaning and Maintenance

 Do not use chemical detergents when cleaning.

 Please unplug the power cord, otherwise it may cause electric shock.

- When there is accumulated dust on the surface, please wipe it with a soft cloth or water below 50°C mixed with neutral detergent and let it dry in the air.
- It's prohibited using any substances that may damage the outer surface.

● **Cleaning of filters**

Please clean these filters once a month when dust and other particles accumulated on them, otherwise it will affect the cooling/ purifying effect.

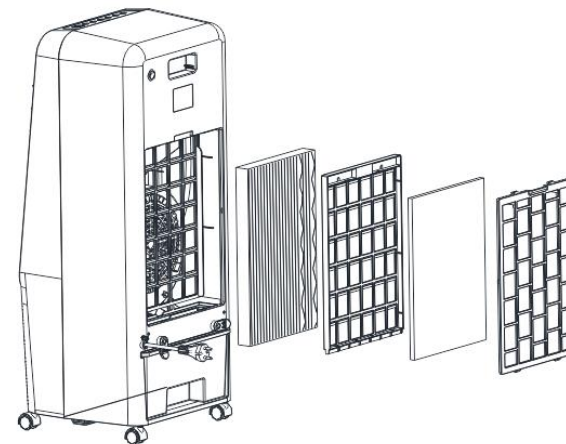

1. Unplug the power cord;
2. Take these filters one by one;
3. Clean the dust-proof filter with detergent and soft brush.
4. Soak the cooling pad in detergent for a few minutes, and then clean and dry it.

● **Cleaning of water tank**

1. Unplug the power cord and take out the water tank.
2. Wipe the scale in the water tank with a little detergent on the towel, and then pour out the sewage after cleaning with water.

● **Cleaning of shell**

1. Wipe the surface with a wet towel. Never rinse directly with water.
2. Do not use corrosive detergent or solvent for cleaning.
3. Be sure to turn off the appliance and unplug the power cord, otherwise there may be electric shock.

● **Installation and use after cleaning**

1. Install the dust-proof filter, HEPA filter, HEPA filter bracket, and cooling pad, and water tank according to the sequence in the figure to ensure the installation is correct.
2. Connect the power supply and check that the appliance is working properly.

● **Maintenance**

1. When the appliance is not used for a long time, unplug the power plug, pack the product and prevent dust from entering it.
2. Before packing, make sure that the cooling pad is dry and there is no water in the water tank.

VI. Technical Parameters

Model	DF-AF1838KH
Rated voltage	220-240V
Rated frequency	50Hz
Rated power	Cooling: 110W; Heating: low level 1200W; high level 2000W
Noise (high)	60≤dB (SPL)
Rated evaporation	1000mL/h
Dimensions	L/346mm×W/314mm×H/823mm
Net Weight	9.7 Kg
Packaging weight	11.7 Kg (including two ice packs)
Executive standards	IEC/EN standards

VII. Environmental Protection



 This marking indicates that this product should not be disposed with other household wastes throughout the EU. To prevent possible harm to the environment or human health from uncontrolled waste disposal, recycle it responsibly to promote the sustainable reuse of material resources. To return your used device, please use the return and collection systems or contact the retailer where the product was purchased. They can take this product for environmentally safe recycling.