



### Highlights

- Constant Force (CF™) patented lift-and-pivot motion technology produces smooth adjustment
- Effortlessly adjust multiple monitors to the most ergonomically comfortable position
- Monitors move in unison, no knobs or levers necessary
- Increase productivity with multi monitor configuration
- Make efficient use of desk space with single compact footprint for multiple monitors
- 13 cm (5") height adjustability
- Integrated cable management
- Monitors can be installed portrait or landscape
- 5 year warranty



# Ergotron® LX

## Dual and Triple Display Lift Stands



### Raise your displays to maximum productivity

Increase productivity and accuracy up to 50% with the innovative Ergotron LX Dual and Triple Display Lift Stands. Stream line your work processes with multi-display computing. With several documents in front of you at one time the LX Dual and Triple Stand enable you to multi-task and keep control over more information while working in an ergonomic environment. This unique solution on the market lets you simultaneously lift and tilt displays with just a touch of the hand for maximum ergonomic comfort.

- 13 cm of height adjustment allows to raise displays to maximum ergonomic comfort
- Move monitors effortlessly in unison, no knobs or levers necessary
- Stream line work processes with multi monitor configuration and improve efficiency



90° pivot for portrait or landscape viewing.

Cables are guided behind the stand for a clutter-free work area.

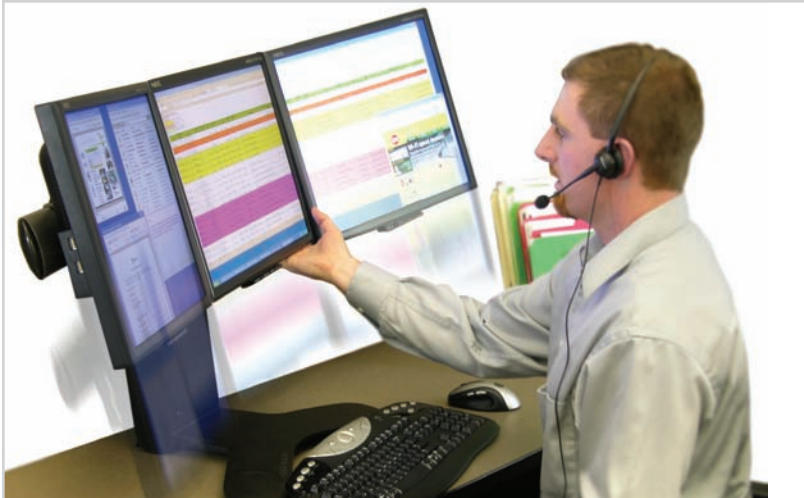
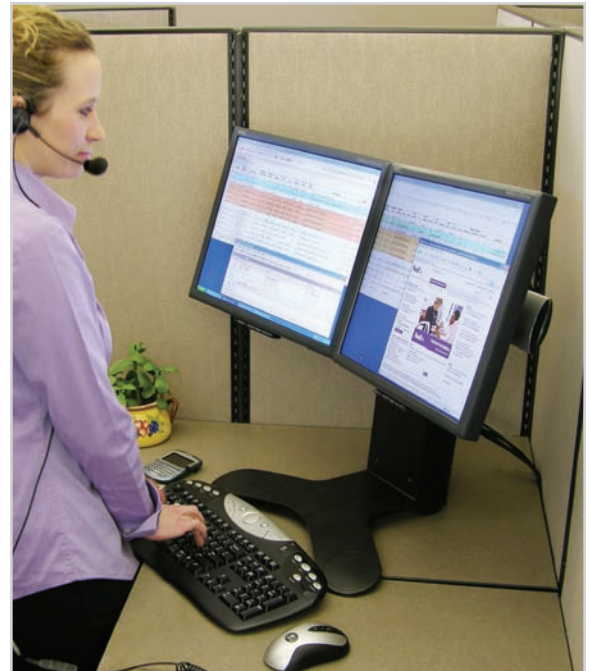

Lift and tilt your displays in tandem.

Why use a multi-screen configuration?

- 33% fewer errors are reported as a result of multi-screen configurations.
- 24% of workers feel more comfortable when using multiple monitors.

Source: NEC Display Solutions/University of Utah/ATI Technologies 2003 study, "Productivity and Multi-Screen Displays"

## Range of Motion

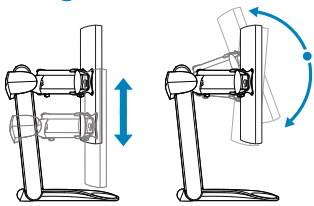

127 mm (5") height range

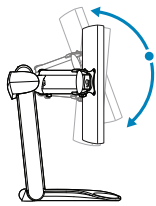

20° (+15/-5°) forward/back tilt

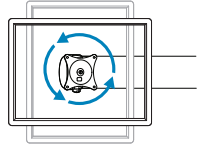

90° portrait/landscape

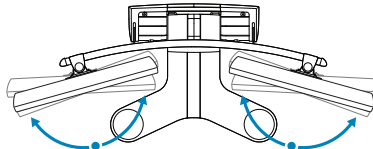

10° right/left pan

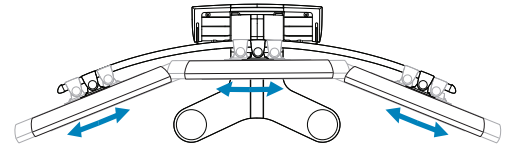

Side-to-side adjustment accommodates different display sizes

## Basic Specifications

**Display Interface Options:** VESA FDMI MIS-D, 100/75, C (hole pattern: 100 x 100 mm & 75 x 75 mm)

**Description:** LX Dual Display Lift Stand  
Part Number: 33-299-195 (black)  
LX Triple Display Lift Stand  
Part Number: 33-296-195 (black)

**Weight Capacity:** Dual 5.4–12.7 kg (12–28 lbs)  
Triple 10.9 – 22 kg (24 – 48 lbs)

**Maximum Display Size:** 58.3 cm (22.9")

**Shipping Weight:** 15 kg (33 lbs)

**Warranty:** 5 year

© 2006 Ergotron, Inc.  
rev. 07/07/2006 870-05-065

**Content is subject to change without notification.**

**Ergotron Europe**  
Beeldschermweg 3  
3821 AH Amersfoort  
The Netherlands  
Tel: +31 33 45 45 600  
Fax: +31 33 45 45 649  
info.eu@ergotron.com  
www.ergotron-europe.com

